

ATTACHMENT B

Snoqualmie Village Drive (Private Road)

SR 906

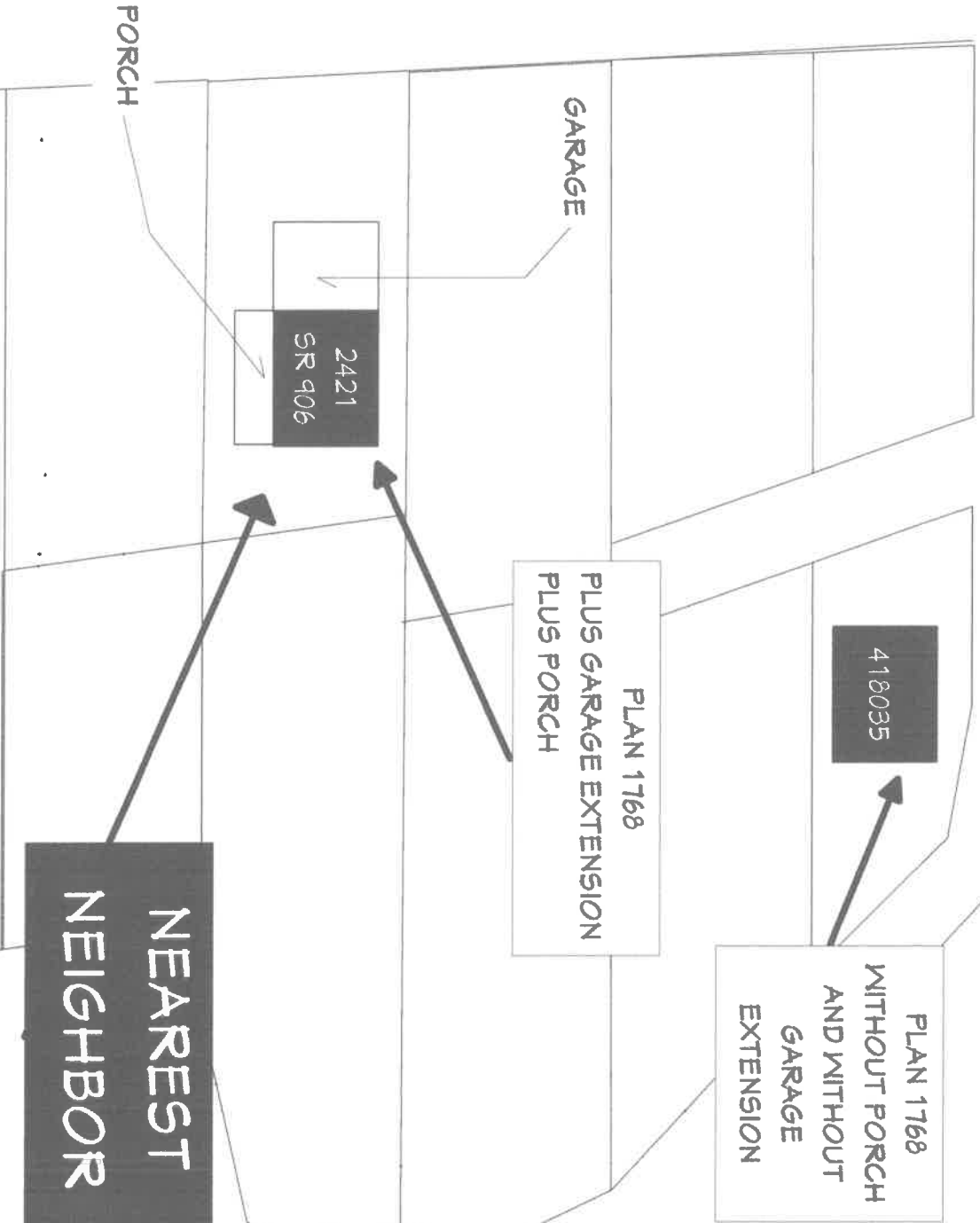

**NEAREST
NEIGHBOR**

RECEIVED
JUN 02 2020



Scale 1/4" = 10'

P-2	Property Overview	Kittitas County Parcel 418035	Prepared by: Greg Gilkeson 1037 NE 65th #191 Seattle, WA 98115
------------	-------------------	-------------------------------	---